

Hey all CPNA'ers,

How about this winter? Kind of nice! Hope this summer is as nice as this winter has been. On February 11 we had our 5th Trash Bash. There was record turnout for the project and the weather was perfect. Picked up lots of trash and recyclables and met lots of new people. Want to thank Leslie Gulledge for organizing the Trash Bash. Leslie has led this effort for 5 years and it would not happen without her. If you see Leslie give her a "high five".

I presume that by now you have noticed all the new trees in Crowley Park and that they are starting to show signs of spring. Hopefully they all make it. The trees would not have happened without the work and effort by Nancy Crowe.

Do not be shy and bashful come to a board meeting, volunteer for a committee or stand for election to one of the board seats. The time you spend helping CPNA will help make our neighborhood great. If you are interested do not hesitate to contact me at 972-238-7254, I will be glad to speak with you.

Seems we have had a recent uptick in auto and home break-ins. As you know the best way to prevent crime is to harden the target. Park your car in the garage or if you leave it outside leave a light on and remove all valuables. When you leave home for an extended period of time make your house look "lived in" and notify your neighbors that you are gone and keep a watch on your home. Go to the Richardson Police web site and you can read all about other ways to prevent crime. Calling the police after you have been a victim is too late. One other way to prevent crime is to join the CRIME WATCH PATROL. To join the CRIME WATCH PATROL contact me at 972-238-7254 and I can fill you in on the details.

Hey this year you get a few extra days to file your income tax – Due April 18. Also enjoy this spring because the 100 degree days will soon be here.

Your Beloved, Most Humble, and Most Esteemed Neighborhood Association President,

Terry Ziegler

PS What do you call a tick on the moon?.....A Luna-Tick!!!

## Upcoming Events

International Potluck | April 22



Salute to Veterans | May 20

Ice Cream Social | June 10



More Info | [crowleypark.com/socials](http://crowleypark.com/socials)

## Spring Is Here... Plant Another Tree



## WE NEED YOUR HELP!

By Nancy Crowe

Spring is upon us again and with it comes one of 2 times each year that is best for planting trees in North Texas. It is time again for a tree planting at Crowley Park as part of the Shade the Trail Program. Our neighborhood has been awesome in partnering with the Richardson Parks Department to provide shade for the trail around the park where no shade has been! We need to continue our efforts particularly on the west and southeast sides of the park to complete our initial goals for this program. We need your help to sponsor a tree for \$200 and dedicate it to someone special, if you desire. The city will match that \$200 to buy the tree, plant the tree, and care for the tree. Please see the Donation Form inside as well as the Donor List of all of our neighbors who have so graciously given to this wonderful program to make our Crowley Park more beautiful for years to come!!

## DONATE TODAY!



# Master Gardener's curb appeal



**Congratulations to Master Gardener Bruce Batman and Jean Wright for sharing their gardens with the city!!** Their homes on North Spring and Blackberry were chosen last Fall to participate in a Water-Wise Landscaping tour of homes.

The inaugural water wise landscape tour was held on October 8, 2016. The event included a tour of six Richardson homes featuring water-friendly outdoor landscapes. The city teamed up with volunteers and passionate homeowners who are eager to answer questions about ways to maximize water savings by choosing native and other plants that thrive in the Texas climate.

Their home of a Collin County Master Gardener converted their landscape to more water wise plants in 2011. The Batmans prefer their landscape to reflect a cottage-type garden with minimal watering needed. There are also six 55-gallon rain barrels and soaker hose in three of the landscape beds to support minimal watering. Some of the native plants in this landscape include Coreopsis, Crinum, Daises, Fall Aster, Mexican Mint Marigold, Mexican Petunia, Purple and White Coneflower, and Society Garlic.

At her home on North Spring, Jean wanted to save time and to cut down the costs of outdoor watering and re-planting. Jean has enjoyed working in her yard since her late 20's and has always wanted to watch things grow. She planted the following water-wise plants that could sustain in the Texas weather: Balloon Flowers, Bamboo Nandina, Butterfly Plants, Cat Mint, Foxtail Ferns, Lantana, Lilly, Salvia, Scabiosa, Skull Cap, Verbenas, Vinca, Youpon Tree.

For more information, contact Michelle Mann at [michelle.mann@cor.gov](mailto:michelle.mann@cor.gov) or call 972-744-4228



## Campout at Cityline Chick-fil-A

The newest restaurant addition to Cityline had their grand opening last month with a campout in the parking lot. The parking lot of the new Chick-fil-A at Plano Rd. and Renner was a camping ground on March 15<sup>th</sup>, as people pitched their tents to vie for the chance to win multiple prizes worth \$250. The first one hundred lucky campers were placed in drawings for various prizes.

There were activities including a trivia game to entertain these campers throughout the day. The restaurant officially opened the following day, March 16<sup>th</sup>. Happy Camping!!



# Trash Bash 2017



- The 2017 Trash Bash broke a record on attendance with a total of 66 participants
- Participants collected 30 bags of trash and 19 bags of recyclable materials.
- Councilman Mark Solomon attended and provided the kick-off remarks.
- E2Imagery provided the audio/visual and public address systems.



- Jaanki Upadhyaya on Honeysuckle won the door prize- Target gift card and Trash Bash T-shirts

## A special Thank You to:

- Janice Tower from the City of Richardson Health Department for Supplies
- Councilman Mark Solomon for event kick-off remarks
- CPNA for promotion in newsletter and signage throughout the community
- CPNA for coffee and Target gift card
- David Eerikainen for AV and PA systems and photography
- Judy Kidd, Conard Kester, Lewis Burton, Trish Sumner, Howard Miles and Doug Brisendine for registering the participants
- Glenda and Dennis Jenkins and Steve Williams for managing the field
- Dennis Pitts, Neil VanHooeydonk, and Charles Gullede for photography
- 66 enthusiastic participants who collected the trash and recyclables

## Free Yoga at CityLine

CityLine, the 186-acre mixed-use, transit-oriented development located at 1150 State St., will once again host free yoga classes in the Plaza every Saturday from 9-10 a.m. in March, April and May.

The outdoor classes are always free, but attendees are encouraged to consider making a small donation toward a highlighted nonprofit. Each month, CityLine will partner with a local nonprofit, including Genesis Women's Shelter and Support, Richardson Symphony Orchestra and Café Momentum.

No preregistration is necessary; participants are encouraged to arrive 15 minutes early and bring a mat. Children are welcome to attend as well. Classes are weather permitting—check the CityLine and Reef Point Yoga Facebook pages for updates. Free parking is available in the CityLine garages.

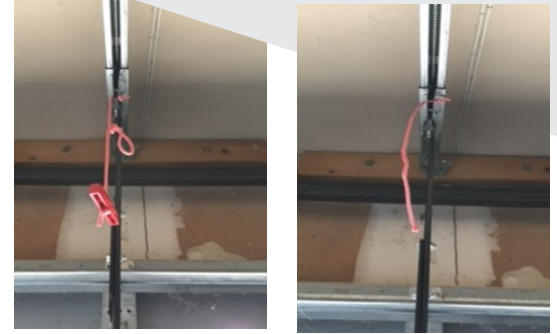

## Protecting Your Garage from Break-Ins

- Keep your garage closed to prevent others from viewing your valuables.
- Lock your garage door opener, especially at night, to prevent burglars from accessing your codes remotely.
- Remove loops and the handle from your auxiliary release cord to prevent burglars from using a tool to release the garage door manually, as seen in the pictures.
- HELP us frustrate all the potential burglars attracted to our neighborhood.
- Burglars cruise our neighborhood looking for easy access to our valuables.

## Spring Fling

Crowley Park Neighborhood Association held its Spring Fling Social at Desperadoes Restaurant on March 21<sup>st</sup>.

Attendees enjoyed an appetizer buffet and door prizes. Door prize winners included Richard Muir, Leslie Gullede, Nancy Crowe, and Jane Mueller.





# Our History

## Who is the Richardson of Richardson, Texas?

*Information from an article by George Lillard and Librarian Stacey Davis*

The logical answer is E.H. Richardson who is listed on the historical marker at City Hall.

*"In 1873 the Houston and Texas Central Railroad was built through Dallas County, bypassing the town of Breckenridge. The citizens moved north to the rail line and named their new town in honor of railroad contractor, E.H. Richardson."*

Researchers from the Richardson Library found little information about an E.H. Richardson other than an 1880 census listing that name as a Dallas grocer. Stacey Davis with the help of others located a January 1, 1896 Dallas Morning News article that follows:

*"Richardson dates its beginnings from or soon after the advent of the railroad into this part of Texas in 1872. The town was named in honor of Mr. A.S. Richardson of Houston, now deceased, who was formerly Secretary of the Houston and Texas Central Railroad Company."*

Ms. Davis uncovered one other document that offers all but conclusive proof. A 1930's transmittal on City of Richardson stationary regarding PATENT No. 636 Vol. 9 W. R. Bodine 320 Acre Survey stating: ...*"City of Richardson was thus laid out, and the town was named in honor of A.S. Richardson, Secretary of the Houston & Texas Central Railroad in the year 1873."*

### A little history about Richardson's namesake:

- Dec. 22, 1822, his father Stephen shipwrecked at the mouth of the Brazos River and made his way to Austin's Colony
- His father began teaching and married Lucinda Hodges in 1829
- S. was born in Austin's Colony on August 16, 1830
- A. S. was 6 years old when the Texas Revolution began
- Age 21 attended Harvard Law School
- Returned to Texas to open a law practice in Houston
- During the Civil War he served one term in the State Legislature
- In 1867 appointed Secretary & Treasurer of the Houston & Texas Central Railway Company
- In 1890 appointed City Secretary of Houston, serving until 1896
- In the summer of 1899 his health failing, he travelled to Canada
- On the return home he passed away on the railway about one hundred miles from his namesake city, Richardson, Texas.

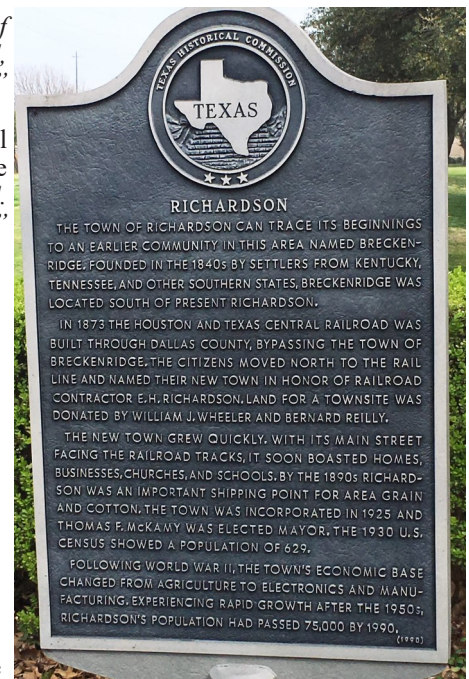
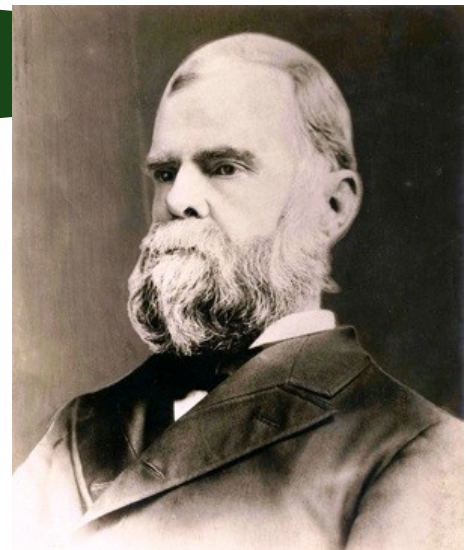



**ALL AMERICAN**  
LAWN & LANDSCAPE

• Lawn Maintenance • Plant Flowers •  
• Landscape Design/Install • Trim Shrubs •

Jason Smith - Owner/Operator

**214.801.9361**

BBB A+ Rating

**Got leaves?**  
Autumn/Winter  
Leaf Removal

**\$10 OFF**

Valid 2018 Holidays/  
New Customers

Call us to be clean for the  
2018 Holiday Season!

*Mama's Memories Antiques*  
Antiques, Vintage and Collectibles

Monday-Friday  
10am-6pm

7602 N Jupiter Rd. #107  
Garland, TX 75044  
P: 972-530-1040  
mamasmemoriesantiques@gmail.com



**LMW Tax Solutions**  
Unlocking Tax Solutions for Challenging Times

**(972) 530-1040**

- IRS Problems Solved
- Business / Personal
- Prior Year Returns
- Bookkeeping / Payroll

luann@lmwtaxsolutions.com 7602 N. Jupiter Suite 107 Garland 75044





# CROWLEY PARK LEADERSHIP

## OFFICERS

**Terry Ziegler, President**  
[terryziegler@zieglers.com](mailto:terryziegler@zieglers.com)

**Bill Kinder, V. President**  
[wjkinder@att.net](mailto:wjkinder@att.net)

**Monica Enfield, Treasurer**  
[monica.enfield@gmail.com](mailto:monica.enfield@gmail.com)

**Dot Pitts, Secretary**  
[dotpitts@gmail.com](mailto:dotpitts@gmail.com)

## COMMITTEE DIRECTORS

**Nancy Crowe**  
**Civic & Environmental**  
[ncrowe3@hotmail.com](mailto:ncrowe3@hotmail.com)

**Glenda Jenkins**  
**Membership & Promotions**  
[dlgljenkins@aol.com](mailto:dlgljenkins@aol.com)

**Rockie Marvel**  
**Publications**  
[rockiemarvel@gmail.com](mailto:rockiemarvel@gmail.com)

**Katy Palasek**  
**Socials**  
[katypalasek@gmail.com](mailto:katypalasek@gmail.com)

**Terry Ziegler**  
**Neighborhood Safety**  
[terryziegler@zieglers.com](mailto:terryziegler@zieglers.com)

**Heather Stevens**  
**Website & Technology**  
[stevenshmj@gmail.com](mailto:stevenshmj@gmail.com)

Have you checked out our new website?  
Visit [crowleypark.com](http://crowleypark.com)

Contact suggest to our leadership team!

Have suggestions, article ideas or  
questions? Submit them and we'll answer  
them in future newsletters!

There are two ways of spreading light:  
to be the candle or the mirror  
that reflects it.

*Edith Wharton*

# CLARITY

## What Do You Want?

By: Tim Marvel | [10secondsdaily.com](http://10secondsdaily.com)

This conversation could go in many directions. We could talk about clarity in driving directions when on vacation. Or we could talk about speaking clearly for more clarity to get your point across. What is more important and what I want to talk about is clarity in your plans. Having a clear vision of what you really want so you can get there. You know the saying if you are going nowhere, any direction will get you there. I was listening to Brian Buffini, one of my favorite motivational speakers today and he was discussing how many thousands of interviews he had conducted over the years. As he began to get to know the person he was talking to he would ask a common question, "what is it that you want out of life, or what is your big goal"? The majority of people can not tell you what they want or their big goal. They would say things like, "this sounds good, and maybe I would like, something like"... These are not the answers that are going to help you move forward. Brian would let the chatter go on for just a minute or so and then would change the question to "what is it that you do not want"? What he found was people had an easier time saying what they did not want. If that is the case for you, when it is easier to define what you don't want, then work backwards. I hope you are moving forward each and every day. There are no free-days, they all count. Make a plan and when asked be clear on what it is that you want. Thanks for joining me today.

## Mark Solomon

**Assurnet Insurance Agency**

**Home—Auto—Health—Business**

*If it has the word insurance...Call us first!*



833 E Arapaho Rd, Ste 107  
Richardson, TX 75081  
214-739-5610

[Markso@assurnet.biz](mailto:Markso@assurnet.biz)  
[www.assurnet.biz](http://www.assurnet.biz)

**ASSURNET**  
INSURANCE AGENCY

*Serving Richardson families since 1986*





# Crowley Park Shade the Trail Donor List

*The following Crowley Park Residents have donated \$200 to purchase a tree:*

## Donor

Kambiz Afkhami  
Kambiz Afkhami  
Larry Bailey  
Eric Chen  
Andrew Chuvarsky  
Sharol Clark  
Kathleen Crowe  
Nancy Crowe & Van Niemela  
Tom and Elaine Dixon  
Monica Enfield & Evan Quaife  
Charles Finch (3)  
Jerri Garison  
Tom and Elaine Gibson  
Glenda and Dennis Jenkins  
Dan Johnson  
Chuck and Joan Johnson  
Bob and Mary Ann Johnston  
Bill and Leslie Kinder  
Kent and Betty Koehler  
Fulchu Li  
Lynne Lofgren  
Rockie and Tim Marvel  
Phyllis and Alan McKinzie  
Dot and Dennis Pitts  
Lewis Rigdon  
Bill Simpler  
Sabrina Skoblionok

## Dedicated To:

Cameron Afkhami  
Michelle Afkhami  
Boyce and Kay Bailey  
Chia Yang and Yu Ying Chen  
Helen Chuvarsky  
Tate Landon Clark  
William Crowe  
Dave and Patti Stevens  
  
Leding Bautista  
  
"Buz" Stuart  
My Family at COR HR  
Micah N. Jenkins  
Todd and Alison Ayrea  
  
Kent and Betty Koehler  
  
Herta and Leonard White  
  
Cynthia Rigdon  
Disabled American Veterans  
Sofia Skoblionok

## Donor

Patsy Srygley  
Heather and Seth Stevens  
Bert and Ruth Wall  
Eric and Terry Willenbrock  
Steven and Penny Williams  
Jean Wright  
Terry Ziegler

## Dedicated To:

Monte R. Srygley  
  
Wall Family  
  
Dorothy Charlene Elbertson Williams  
Judy Neslage

*The following Crowley Park Residents have donated \$20-199 toward the purchase of a tree.*

Elena Basurto  
MaryAnne Coelln  
Sandy and David Maher-Smith  
Tanya Nguyen  
Roy and Beverly Ridley  
D Max Waitfield  
Shana and Mike Wiessing

Josie Capps  
Fulchu Li  
Donna Newton  
Phil Nordquist  
Naomi and Joe Steede  
Tsu Ching Liu and Peggy Wang  
Clifford and Jean Wright

MAKE A  
DONATION

CROWLEY PARK

## "SHADE THE TRAIL" DONATION FORM

Donation Date

First Name: \_\_\_\_\_ Last Name: \_\_\_\_\_

Address: \_\_\_\_\_

Phone: \_\_\_\_\_ Email: \_\_\_\_\_

Payable to: CPNA • Memo: "Shade the Trail" • Mail Checks: PO Box 830114, Richardson, TX 75083

Two Possible Options:

1. \$200.00 donations purchases a tree for someone special

Name of special someone:

2. Donation of any amount toward the "Shade the Trail" fund to plant trees in the park.

Amount: \_\_\_\_\_ Check#: \_\_\_\_\_



# Coffee Grounds in the Garden

Information from an article by Heather Rhoades

- Composting with coffee is a great way to make use of something that would otherwise end up in our landfill. These coffee grounds will add nitrogen to the compost pile or your flower beds and garden.. Coffee grounds are considered green compost material and will need to be balanced with some brown compost material.
- Coffee grounds can be put straight into the soil as a fertilizer. The grounds add organic matter to the soil, which improves drainage, water retention and aeration in the soil. The used coffee grounds will help microorganisms beneficial to plant growth as well as attract earthworms. Add 2 cups of coffee grounds to 5 gallons of water and allow it to steep overnight. Mixing these two ingredients is one of the simplest ways to make homemade fertilizer.
- A barrier of coffee grounds around the plants may protect them from slugs and snails.
- Put coffee grounds in the soil to keep cats from digging in the garden.
- Put coffee grounds around the soil of acid loving plants such as roses, rhododendrons, holly, gardenias, increasing acidity and nutrients in the soil.



**We all love our pets, but what do we do with all those empty pet product- containers??**

Here are some ideas for reusing your pet products.

1. Water bottles and other beverage containers can be made into bird feeders. For instructions visit: <http://birding.about.com/od/birdfeeders/a/Make-A-Plastic-Bottle-Bird-Feeder.htm>
2. Pet food bags make usable tote bags. Visit <http://www.instructables.com/id/Funky-recycled-pet-food-bag-pursetote/>
3. Cat litter containers can be used for container gardening by adding some compost and potting soil.
4. Plastic shopping bags can be turned into braided dog leashes. Visit : <http://www.instructables.com/i/How-To-U/cyc;e-Plastic-Shopping-Bags-Into-A-Braided/>
5. You can always recycle the following materials. For more information check out details at [www.cor.net/recycling](http://www.cor.net/recycling)
  - Aluminum, steel, and tin containers
  - Plastic containers
  - Corrugated cardboard and boxboard
  - Glass bottles and containers
  - Newspapers and mixed papers
  - Wax coated paper drink containers
  - Dry cleaning and grocery bag

**PAPPY'S  
PET LODGE**  
Award Winning Pet Care

**BEST  
ID  
2015**

- Clean, playful, & loving experience
- Frequent outside breaks
- One-on-one love sessions
- Experienced, talented groomers
- Rooms for all sizes & temperaments
- Daycare with live webcams
- Staff certified in Pet First Aid & CPR
- Insured and bonded pet sitters

**BRING IN THIS AD AND RECEIVE \$5 OFF ANY SERVICE!**

**Richardson**  
401 President George Bush, 972-919-1900  
**Addison**  
15530 Quorum Dr, 972-290-0485  
**SW Plano**  
1101 Ohio Drive #101, 214-473-9869



[PappysPetLodge.com](http://PappysPetLodge.com)





# The Art Throughout City Line

To liven up the streetscape, KDC's had a vision for a live-work-play environment that included the installation of sculptures, providing a backdrop for the urban landscape. Walt Mountford, KDC executive vice president, said in a statement. "We are proud to welcome five unique pieces, by both local and national artists, each of which is unique in character and provides visitors with inspiration, entertainment and joy."

The largest of the installations is the 23-foot tall *Over the Moon* sculpture by Gordon Huether. A 71/2 foot-tall Texas longhorn sits on top of a crescent moon. (pictured right)

Artists Timothy Berg and Rebekah Myers created the bright green ceramic rabbit, located near the DART rail station at CityLine.



Dallas sculptor Angela Mia De La Vega created a bronze sculpture depicting two children playing.



Houston-based sculptor Joseph Havel's piece at CityLine is made from bronze and translucent resin and depicts a column of books. This sculpture is located on the plaza.

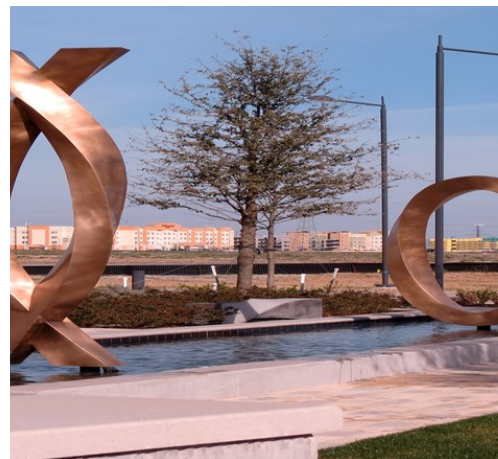

Cliff Garten's *Retexo* sculpture has been installed on the east side of Plano Road in a fountain.

## Enjoy a City Line meal and then walk through the area to locate these additions to the skyline.



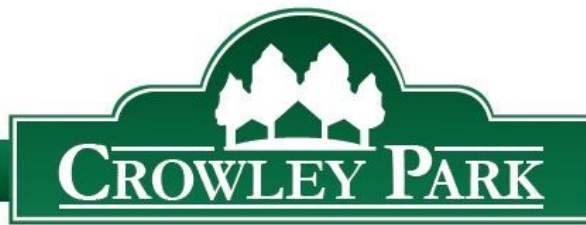

## RESIDENT BENEFITS

Dear Neighbors,

We are fortunate to be in our 7<sup>th</sup> year as a fully-functioning Crowley Park Neighborhood Association (CPNA). To clarify, CPNA is voluntary and NOT a homeowners association.

*"CPNA is a **voluntary** group that strives to develop the lines of communication with the city, promote a safe, clean and attractive community, and bring residents together to preserve and enhance the livability and value of our neighborhood."*

CPNA is open to home owners and tenants alike, **BUT, we need your support! We want to continue to be "your voice" and offer these great benefits and services.** Please be a part of the Crowley Park community by contributing your dues and volunteering your time and talents.

**Membership dues are *only* \$25 per year, per household and provide & facilitate the following valuable services:**

- ❖ Crime Watch Patrol – by trained neighborhood volunteers
- ❖ Beautification & Civic Projects (as approved by the City and budgetary constraints)
  - ~ Crowley Park "Trash Bash" and "National Night Out", City sponsored events
  - ~ Crowley Park entry signs
  - ~ Street sign Toppers
  - ~ Flag Program through Rotary Club (\$40/household/year to participate)
  - ~ Clean & paint perimeter wall @ Jupiter & Renner
  - ~ Various ongoing community projects
  - ~ Shade the Trail Initiative sponsored by CPNA & residents
- ❖ Special Events
  - ~ Spring fling Mixer (March)
  - ~ International Potluck (April)
  - ~ Annual Meeting (September)
  - ~ Salute to Veterans (May)
  - ~ Ice Cream Social (June)
  - ~ Fall Festival (October)
- ❖ Representation at City of Richardson meetings and coordination of matching projects.
- ❖ Interaction with Richardson Police and Fire Departments.
- ❖ CPNA Neighborhood News newsletter. Distributed quarterly.
- ❖ Neighborhood Website ([www.CrowleyPark.com](http://www.CrowleyPark.com))
- ❖ CPNA Social Networking Site limited to residents only: (<https://crowleypark.nextdoor.com>)

***Please complete your Membership Form today.***

***Thanks in advance for your support!***



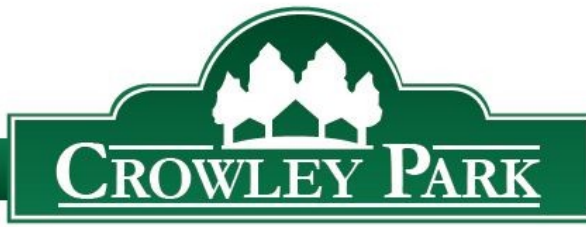

## CPNA MEMBERSHIP APPLICATION

**October 1<sup>st</sup>, 2016 - September 30<sup>th</sup>, 2017**

**Application Date** \_\_\_\_\_

**First Name** \_\_\_\_\_ **Last Name** \_\_\_\_\_

**Other Adults** \_\_\_\_\_

**House Address** \_\_\_\_\_

**Phone (** \_\_\_\_\_ **)** \_\_\_\_\_

**Email** \_\_\_\_\_

*(For communicating planned events, meetings, and alerts)*

**Payment (\$25)** ☐ CASH ☐ CHECK # \_\_\_\_\_

*Payable to CPNA and mail with completed form to:*

*CPNA, P.O. Box 830114, Richardson, TX 75083*

**Volunteering** (check all that applies):

- ☐ Neighborhood Safety (Crime Watch Patrol)
- ☐ Flyer-Newsletter Distribution
- ☐ Welcome Committee
- ☐ Newsletter Writer/Editor

**Social Events** (Please pick one):

- ☐ Trash Bash (February)
- ☐ Spring Fling (March)
- ☐ International Potluck (April)
- ☐ Salute to Veterans (May)
- ☐ Ice Cream Social (June)

*THANKS FOR YOUR SUPPORT!*

**Crowley Park Neighborhood Association**

For more information contact Glenda at 972-680-0885

Payment Date: \_\_\_\_\_

## DID YOU KNOW?

- Settlers came from Kentucky and Tennessee settled around Richland College area in the 1840s
- After the Civil War a railroad was built northwest of the original settlement, shifting the original settlement closer to the railroad.
- Richardson was chartered in 1873 and the town was named for Alfred Stephen Richardson. (See accompanying article about the city's namesake.)
- In 1910 the population of Richardson was approximately 600.
- The town incorporated and elected a mayor in 1925.
- By 1940 the population was approximately 740.
- After World War II and through the 1950s, the city's population continued to grow with the opening of Collins Radio, Central Expressway and Texas Instruments.
- The University of Texas at Dallas was created in the 1960s.
- By 2014 the population of Richardson was estimated to be 108, 617.



In the January 2017 State of the City presentation, city officials shared the evolution of Richardson, beginning with the 1960-1980 AGE OF DISCOVERY. This period included the arrival of Collins Radio, Texas Instruments, and University of Texas at Dallas. During this time period Richardson annexed a significant amount of land in the northeastern panhandle. This included the Crowley Park neighborhood.

The 1980-2000 period is labeled the AGE OF GROWTH, with the largest influx of residents. Blue Cross Blue Shield, Fujitsu, Fossil and Cisco built corporate campuses around the city. Other companies included Samsung, Ericsson, Siemens. Richardson became known as the Telecom Corridor.

The 2000-Present was labeled AGE OF INNOVATION. With KDC's CityLine development, anchored by State Farm, and the new Palisades project, Richardson now has less than 10 percent of its land available for new development. This has led to a new balance for economic development to focus on attracting the best uses for remaining undeveloped land with increased efforts to attract opportunities for redevelopment. The focus is to create locations that provide housing, retail, entertainment and recreational attractions within walking distance.

Future reinvention included the enhancement/redevelopment zones. These include North Central Expressway, Coit Road, areas of Arapaho Road, Main Street and Spring Valley Road. For more details go to State of the City information at [cor.net/StateOfTheCity](http://cor.net/StateOfTheCity).



**ROCKIE MARVEL**  
**214-801-0908**  
**RockieMarvel@gmail.com**  
**www.RockieMarvel.com**  
**Crowley Park Realtor®**  
**and Neighbor**

## For ALL Your Real Estate Needs...

**Moving Up? Downsizing? Empty Nesters?**  
**Just Married? Divorce? Relocating?**

**No matter what curve ball life throws at you, you need someone you can trust. Call Rockie today for a Free, No Obligation consultation to review your options.**

**(214) 801-0908**



501 W George Bush #125  
 Richardson, TX 75080

## ★ Richardson Flags ★

Show your patriotism and support your community. Join the flag program in Crowley Park. Get flags in your yard for \$40 per year. Proceeds provide scholarships for RISD Students. Local Girl Scouts and Boy Scouts earn revenue by participating in this program.



**\$40 Per Year**

**Delivery, Setup and Removal for Five Holidays**

- Memorial Day
- Flag Day
- Independence Day
- Labor Day
- Veteran's Day

**Sign Up Online**  
**RichardsonFlags.org**

**972-725-7150**

**info@RichardsonFlags.org**



**League of Women Voters of Richardson  
Will Hold a Candidates Forum**



The League of Women Voters of Richardson will hold a mayoral and city council candidate forum. The public meeting will be held on Wednesday, April 19, 2017 at 7:00 pm in the Grand Hall of the Richardson Civic Center, 411 W. Arapaho Road, Richardson, TX 75080.

The mayoral and city council candidates are as follows:

Place 1 – Bob Dubey

Place 2 - Mark Solomon

Place 3 - Scott Dunn

Place 4 – Cory Montfort and Mabel Simpson

Place 5 – Marta Gomez Frey and Kashif Riaz

Place 6 - Steve Mitchell

Place 7, Mayor – Jared Weadon and Paul Voelker

Unopposed candidates will not participate in the question and answer part of the forum, but will be given the opportunity to make a closing statement. Questions from the audience can be submitted at the time of the forum or they can be submitted in advance by sending them to [voterservice@lwvrichardson.org](mailto:voterservice@lwvrichardson.org). Emailed questions will be given the same consideration as questions submitted at the event. The questions will be screened according to *League of Women Voters of Texas Guidelines*. The forum will be streamed live on [www.cor.net](http://www.cor.net) and broadcast live on the City's cable TV channel on Time Warner Cable, channel 16 and AT&T U-Verse, channel 99. Taped replays of the forum will also be available on the website and the City's cable channel. For more information on the May 6, 2017, election, visit the League of Women Voters of Richardson's website: [www.lwvrichardson.org](http://www.lwvrichardson.org). The meeting is funded by the League of Women Voters of Texas Education Fund through donations from Richardson area residents and businesses.

**YOUR CHANCE TO  
MEET THE CANDIDATES**

**The best preparation for tomorrow  
is doing your best today.**

*H. Jackson Brown, Jr.*



**Need a professional Property Management Co.?**

Our services include –  
single/multi-family units, HOA and Condo Assocs.

[www.pmistaroftexas.com](http://www.pmistaroftexas.com)

972-672-7221

[Krishna@pmistaroftexas.com](mailto:Krishna@pmistaroftexas.com)



Kanam Realty Group, Broker



**We're  
LOCAL**

**We're  
GLOBAL**

Bringing Buyers and Sellers Together

**Cummings-Wiessing Group**

**Marsha Cummings  
214-957-7153**

**Shana Cummings-Wiessing  
214-543-5559**

[marshana@ebby.com](mailto:marshana@ebby.com)



**DR. JINNA MANN**

***Family Chiropractor***

**Pediatric | Prenatal**

**Family | Sports**

P: 214.276.6700

F: 214.276.6705

[info@cruciblechiropractic.com](mailto:info@cruciblechiropractic.com)

3617 Shire Blvd, Suite 200

Richardson, TX 75082

[www.cruciblechiropractic.com](http://www.cruciblechiropractic.com)



# SUSH! GO

TAKE-OUT & DELIVERY

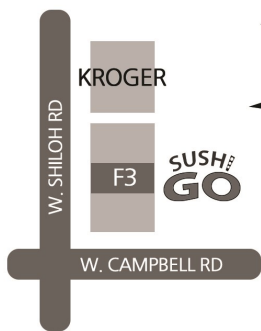

**ANY  
SPECIAL ROLL  
\$7.95**

**Tel (469)814-9940**  
6850 N. Shiloh Rd. Suite F3  
Garland, TX 75044

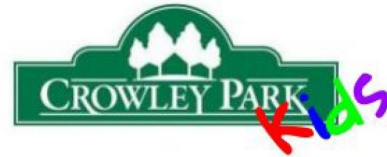

## News:

The International Potluck is coming up on April 22 which is also Earth Day! One way to get to know our corner of the earth better is with Geocaching! If you don't know what Geocaching is, it's "The World's Largest Treasure Hunt"! We have over 2,000 Geocaches just in Richardson! Before Pokemon Go there was a similar activity, Geocaching. All you do is download a Geocaching app and find the real life 'treasure' using the coordinates. Another fun part of it is that you can leave a treasure yourself, log the coordinates and watch from your app as kids log that they found it! You should always put it back so more kids can participate. Happy Hunting!

## From the kids:

What do you call a bear with no teeth?  
A Gummy Bear!  
(Submitted by Brooke, age 8)

## Hey kids, did you know?

It's impossible for people to lick their elbow. Try it!

An ostrich's eye is bigger than it's brain!

Find us on Facebook: Crowley Park Kids



A  
RICHARDSON  
COMPANY  
"LET'S MAKE IT  
YOURS!"



**ADAPTIVE RENOVATIONS, LLC**  
REMODELING & CONSTRUCTION | (214) 856-8232  
[WWW.LETSMAKEITYOURS.COM](http://WWW.LETSMAKEITYOURS.COM)

## IS YOUR ROOF 7 YEARS OR NEWER?

*The Newer the Roof the Bigger the Savings!*



"You deserve local  
expertise — not a  
1-800 number.  
Call us to experience  
the difference"  
—Jacob Ashwander,  
Agency Owner



**Allstate**  
You're in good hands.

Se Habla Español

**The Ashwander Agency**

7602 N. Jupiter Rd., Suite 110  
Garland, TX 75044

**469-334-0993**

[www.Ashwander.com](http://www.Ashwander.com)





## WELCOME COMMITTEE PROGRAM

CPNA's "Welcome Committee", was formed for the purpose of welcoming new residents into Crowley Park. Welcome Books are filled with information about Crowley Park and the City of Richardson. These books were compiled by the committee and are being distributed to new residents monthly. If you have not received your Welcome Book, FREE blue recyclable bags and Goodie Bag please contact Glenda Jenkins at [dlgljenkins@aol.com](mailto:dlgljenkins@aol.com).

Please join us in welcoming our latest new members to our wonderful neighborhood:

Allison Potter on Acacia St  
Hungs & Simon Cho on Blue Bell Pl  
Deborah & Marvin Young on Blue Cypress Dr  
Rick & Audrey Cannon on Buttercup Dr  
Lakeesha Browne on Carnation Dr  
Keith George on Greenpark Dr  
David & Tu Peerson on Honeysuckle Dr  
Heather & Seth Stevens on Honeysuckle Dr  
Amber Mendoza & Caleb Meacham on Mum Dr  
Huikun Wu on Primrose Dr

**WELCOME TO CROWLEY PARK!!!**

## SPRING PLANTING GUIDE



### Vegetables for Spring planting

Cucumber	through end of April
Eggplant	through end of April
Cantaloupe	through end of April
Peppers	through middle of May
Southern Peas	through end of June
Sweet Potato	through middle of May
Tomato	through middle of May
Watermelon	through end of April

### Mosquito Repellant Herbs

Lemon Balm-	best planted in pots
Catnip Basil	toxic to mosquito larvae
Lavender	best rubbed on skin to release oils
Peppermint	repels adult and kills larvae/ eggs of
several species Citrusum	rub crushed leaves on skin
Sage or Rosemary	around a fire, burning repels insects
Pennyroyal	best rubbed on skin



**Spinning Wheel**  
ALTERATIONS AND TAILORING

- ALL TYPES OF ALTERATIONS •
- TAILORING •
- FELTING •
- KNITTING / CROCHET •
- HANDSPINNING FIBER INTO YARN •

We offer all types of custom alterations and tailoring, for all ages, tastes and fashions.

We can do alterations on bridal wear, formal and casual wear. As well as work with leather and fur, adjust uniforms, drapery/curtains, seasonal wear, biker's vests, riding suits, Irish dance dresses, prom dresses, children's costumes, pet's costumes, pillows, bags, belts and secure patches.

We can resize garments, modify hems, taper waists or sides and shorten or lengthen sleeves. We can also do small repairs, such as adding new buttons and snaps, replacing zippers and pulls and much **MORE!**

We will be happy to serve you! *Olya Boroditskova*



3443 W.CAMPBELL RD #780  
GARLAND TX 75044  
Phone: (469) 814 0122  
Email: [spinningwheelalterations@gmail.com](mailto:spinningwheelalterations@gmail.com)  
[www.spinningwheelalterationsandtailoring.com](http://www.spinningwheelalterationsandtailoring.com)

**Darren's**  
**AMERICAN GRILL**

7602 N. Jupiter Rd. #100 • Garland, TX 75044 • 972-414-4009

Buy one entrée get a second  
one of equal or lesser value

**FREE**

Limit 10 dollar value please and one coupon per party.

We also have a private dining room onsite for parties of 20 or less at no charge, based on availability. Adult beverages are also available from our full service bar, including Bud Light, Shiner Bock and Dallas Blonde beer on tap!

Preparedness Tip:

# Plan for Unique Family Needs

Each household in Richardson is different, talk with your family members to identify your household's unique needs.

## ***What can members of your household NOT be without for 72 hours?***

Is there a young infant or child in your home?  
Do you have a pet?  
Does anyone require specific medication?  
What about aids like a walker/cane, glasses, or contacts?  
Items like baby formula, diapers, dog food and leashes  
can be hard to find in a disaster. Document prescription  
specifics and keep a copy of your driver's license.

**BUILD A KIT**  
Include enough food, water, and medical supplies for your needs in your emergency kit to last for at least 72 hours.



Being prepared allows first responders to help those who are physically injured.  
Remember responders live in our community and may also be impacted by the incident.

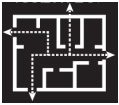

**Let's Get Ready Richardson!** *Your planning and supplies could be the difference between remaining in your home or needing to seek shelter in an emergency.* Resources, sample plans, and links are available online at [www.cor.net/em](http://www.cor.net/em) or for more information call 972-744-0900.

## Whitening Your Teeth at Home

Information from an article by Steph Simpson

According to the American Academy of Cosmetic Dentistry, the most common thing that people want to change about their smile is often the whiteness of their teeth. There are natural, everyday ingredients that can accomplish that beautiful smile.

1. Brushing your teeth with mashed strawberries. Simply mash up one or two ripe strawberries, dip your toothbrush into it and then brush your teeth as normal. Rinse mouth thoroughly with a pinch of bicarbonate of soda in order to reduce the acidity in the mouth and help to protect the teeth from any damage.
2. Coconut oil is considered a natural teeth-whitening remedy. Swill oil around in the mouth for a few minutes like a mouthwash. This use of coconut oil actually helped to reduce plaque formation on the teeth and also helped to reduce gum disease.
3. Mix a teaspoon of lemon juice with enough baking soda to make a paste. The baking soda is mildly abrasive to remove surface stains and is very alkaline, so it helps to neutralize the natural acidity of the lemon juice.
4. Dip your toothbrush into food grade, activated charcoal powder (not the charcoal from the barbecue). Brush as normal to remove any stains on the teeth.
5. Rubbing teeth with the inside of an orange peel is widely regarded as a safe, natural way to whiten teeth at home. The white part of the peel contains limonene, a substance that is used in many commercial teeth whitening products.
6. Try crushing up dried basil leaves to form a mildly abrasive powder and missing with mustard oil for a fast, effective way to whiten teeth at home. You can also use fresh basil leaves crushed into a paste and applied directly onto the teeth using a toothbrush.
7. Try brushing teeth with a tablespoon of apple cider vinegar to help to remove stains, and then gargle with a mouthful to help freshen breath and kill bacteria around the gums.
8. Combine baking soda and sea salt to create an antibacterial "tooth scrub" that counteracts the acids in the mouth and also eliminates bacteria.
9. Turmeric is an anti-inflammatory, antimicrobial, and contains antioxidants, making it effective for treating common dental problems like gum disease. In the form of a fine powder it acts as a gentle abrasive, removing surface stains and revealing whiter teeth. Simply rub about a teaspoon's worth over your teeth using our finger, brush with a clean toothbrush and rinse.

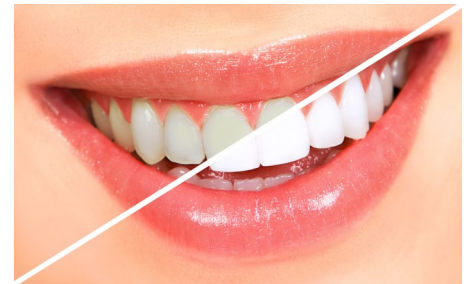





## 25 Years of Wildflowers, Music and Art!

**Wildflower!** Arts & Music Festival began in 1992 as a small community event held in Breckinridge Park in northeast Richardson, Texas. After 25 years the festival has grown to become the area's most recognized and anticipated musical event.

What began as a springtime community event to celebrate the wildflowers planted throughout the city, quickly "blossomed" after only the second year when national headlining entertainment was added to the event. Growing crowds and subsequent logistical challenges lead the event to its first move from Breckinridge Park to the Greenway Corporate Office Park at US75 and Campbell Rd. It was here that fledgling event was able to expand and eventually grew to cover over 30 acres featuring multiple stages, arts, music, exhibits, and family activities.

In 1998, the **Wildflower Nights!** Program was added bringing an additional weekend of concert-style entertainment to the event. **Wildflower Nights!** featured evening concerts in an amphitheater setting and the program quickly gained popularity as bigger and better artists were added to the lineup each year.

In 2002, Wildflower once again relocated to accommodate the growing needs of the event. Our current location is the Galatyn Park Urban Center, a newly designed commercial and residential location that features the Renaissance Hotel, corporate offices Bank of America, and Blue Cross Blue Shield of Texas, AMLI Galatyn Station Apartments, the Eisemann Center for Performing Arts, a festival plaza, and a DART light rail station.

Today the festival routinely draws 62,000 fans annually and now boasts six performance stages, four outdoor and two inside the Eisemann Center, where close to over 100 musical acts are showcased.

This year the **Wildflower! Arts & Music Festival** will be held May 19-21. Already announced headliners include a variety of award-winning eclectic performers to help commemorate the Festival's 25 years of music, art and food.

Tickets were made available for purchase on April 1. For a complete list of bands and up-to-date event information, visit [www.wildflowerfestival.com](http://www.wildflowerfestival.com) and follow **Wildflower!** on social media.



## SILVER BULLET POOL CARE

22 years experience, locally owned, and operated.  
Affordable and professional, reliable service

"We're the best, because we're better than the rest,  
and we cost less."

\*We will meet or beat any competitors price, or  
10% off and we will honor any competitors coupon.

- Weekly Pool Care
- Chemicals
- Filter Cleans
- Pool School
- Tile Cleaning
- Equipment repaired & replaced
- Parts
- Party preparation
- All year round service
- Special cleanings



214-254-7956



## NO ONE DOES MORE FOR VETERANS

Veterans of Foreign Wars

Desert Storm | Afghanistan |  
Kosovo Campaign | Somalia | Iraq Wars

VFW3530.COM



Non-Smoking Post